

Waterwise Garden Designs



Waterwise Garden Designs



“The Dunes”

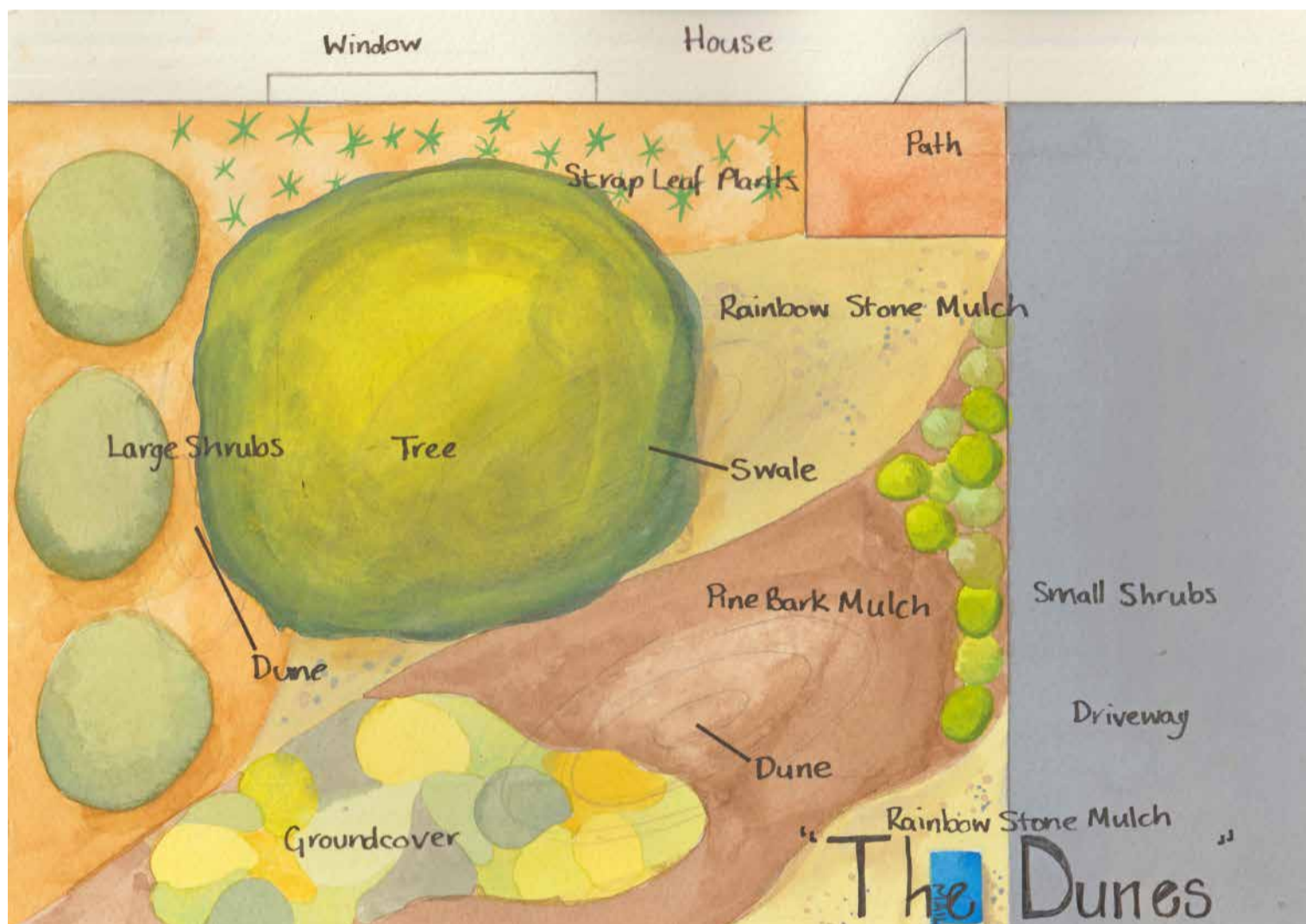

To ensure your garden thrives in our tough conditions, it will feature latest advances in sustainable landscaping. This includes;

- Special soil amendments
- Super tough waterwise plants
- Drip irrigation
- Specialist wetting agents
- Superior mulches
- Hard landscaping bonuses

Indicative Species List

Trees (small, 4-12m tall)	Medium-Large Shrubs (2-3m tall)	Small Shrubs (1-1.5m tall)	Strapleaf Plants (0.3-1m tall)	Ground cover
<i>Eucalyptus spathulata</i> 'Swamp Mallet'	<i>Calothamnus quadrifidus</i> 'One sided bottlebrush'	<i>Acacia</i> 'Fettuccini'	<i>Conostylis candicans</i> 'Grey Cotton Heads'	<i>Carbobrotus</i> 'Native Pigface'
<i>Eucalyptus vitrix</i> 'Dwarf desert ghost gum'	<i>Grevillea olivacea</i> 'Coastal Grevillea'	<i>Eremophila</i> 'Pink Passion'	<i>Lepidosperma gladiatum</i> 'Coastal Sword Edge'	<i>Eremophila</i> 'Rottnest Eremophila'
		<i>Guitinotia ledifolia</i>		<i>Myoporum purpurea</i> 'Purple Myoporum'
		<i>Olearia axillaris</i> 'Little Smokey'		
		<i>Westringia fructose</i> 'Native Rosemary'		

Colourful cultivar small shrubs: *Eremophila nivea* 'Spring Mist', *Grevillea* 'Gild Dragon', *Westringia* 'Lilac and Lace'

Colourful cultivar small strapleaf plants: *Poa* 'Eskdale'

Mass plantings: *Ficinia nodosa* 'Knotted Club Rush', *Juncus kraussii* 'Shore Rush', *Lepidosperma gladiatum* 'Coastal Sword Edge'

Climbers for fences: *Hibbertia scandans* 'Snake Vines'

Waterwise Garden Designs



“The Reserve”

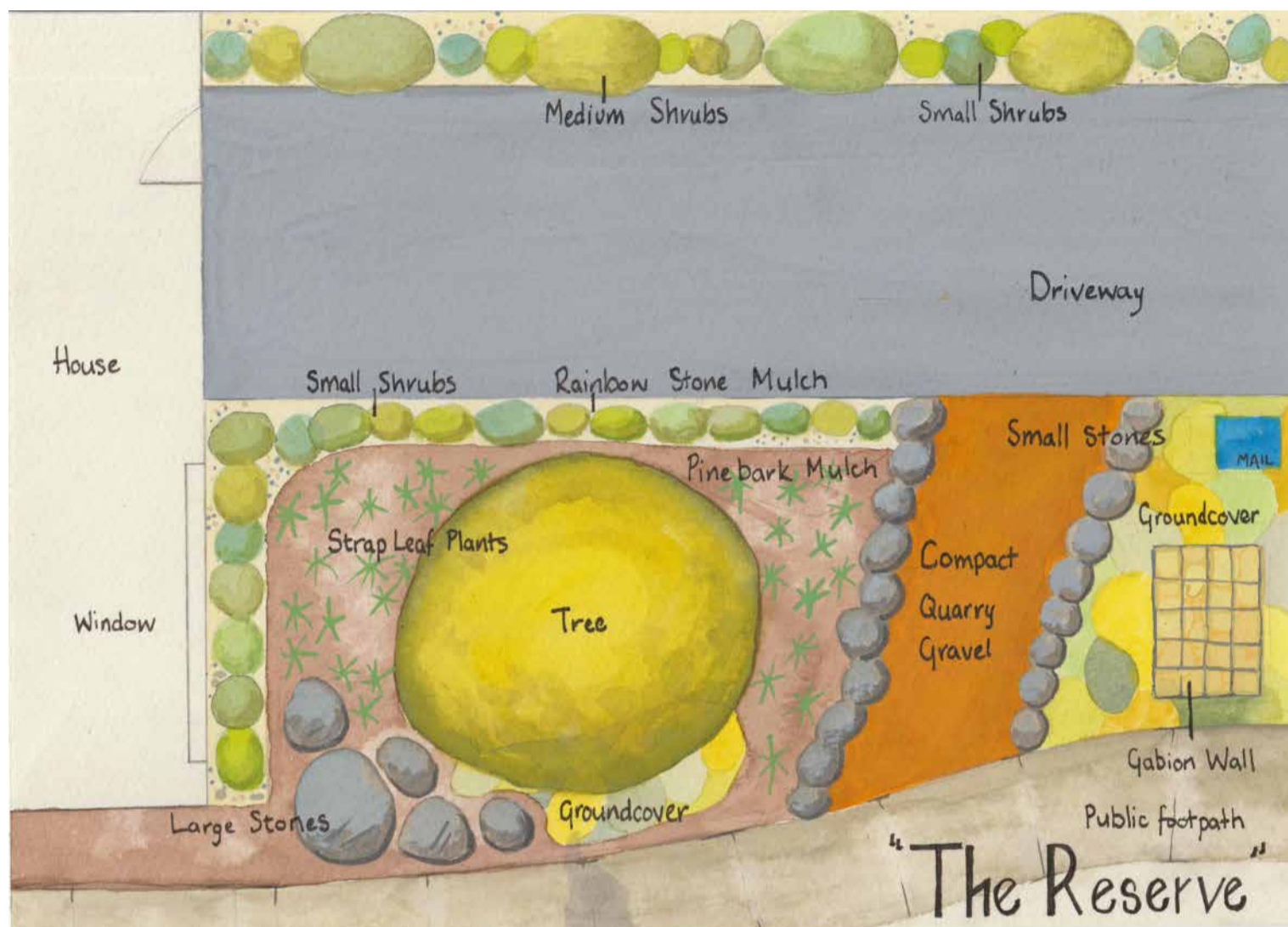

To ensure your garden thrives in our tough conditions, it will feature latest advances in sustainable landscaping. This includes;

- Special soil amendments
- Super tough waterwise plants
- Drip irrigation
- Specialist wetting agents
- Superior mulches
- Hard landscaping bonuses

Indicative Species List

Trees (small, 4-12m tall)	Medium-Large Shrubs (2-3m tall)	Small Shrubs (1-1.5m tall)	Strapleaf Plants (0.3-1m tall)	Ground cover
<i>Eucalyptus caesia</i> 'Silver Princess'	<i>Beaufortia sparsa</i> 'Fiery sand bottlebrush'	<i>Eremophila nivea</i> 'Spring Mist'	<i>Anigosanthus</i> 'Big Red'	<i>Goodenia hederacea</i> 'Ivy Goodenia'
<i>Eucalyptus erythrocorys</i> 'Illayarrie'	<i>Grevillea</i> 'Ellendale Pool'	<i>Leucophyta brownii</i> 'Canal Rocks'	<i>Anigosanthus</i> 'Bush Ballad'	<i>Grevillea crinitifolia</i> 'White Grevillea'
	<i>Grevillia olivacea</i> 'Apricot Glow'	<i>Maireana</i> 'Blue Bush'	<i>Anigosanthus</i> 'Federation Flame'	<i>Grevillea</i> 'Gin Gin Gem'
	<i>Grevillia thelemaniana</i> 'Spidernet Grevillea'	<i>Pimelea ferruginea</i> 'Coastal Banje'	<i>Lepidosperma squarratum</i>	<i>Hemiandra pungens</i> 'Snake Bush'
	<i>Melaleuca nesophyla</i> 'Little Nessie'		<i>Ptilotis</i> 'Little Joey'	<i>Kennedia prostrate</i> 'Running Postman'
	<i>Ricinocarpus tuberculatus</i> 'Wedding Bush'			<i>Myoporum</i> 'White Myoporum'
				<i>Rhagodia</i> 'Berry Saltbush'

Colourful cultivar small shrubs: *Chamelaucium* 'Lady', *Eremophila nivea* 'Spring Mist', *Thryptomene* 'Tickled Pink' 'Supernova'

Climbers for fences: *Hibbertia scandans* 'Snake Vines', *Sollya heterophylla* 'Native Bluebells'

Waterwise Garden Designs

“Nature Play”

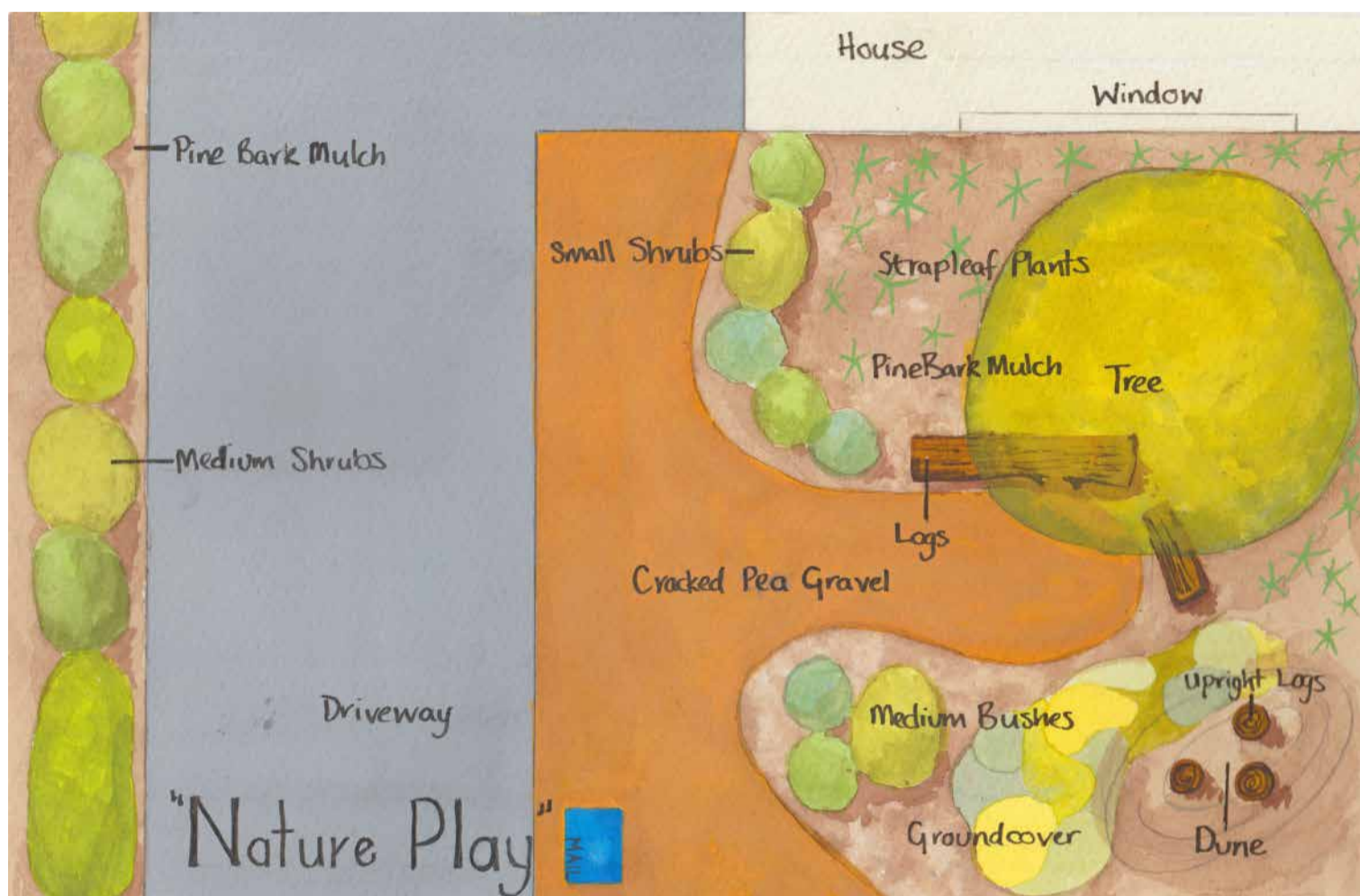

To ensure your garden thrives in our tough conditions, it will feature latest advances in sustainable landscaping. This includes;

- Special soil amendments
- Super tough waterwise plants
- Drip irrigation
- Specialist wetting agents
- Superior mulches
- Hard landscaping bonuses

Indicative Species List

Trees (small, 4-12m tall)	Colourful Cultivar Small Shrubs	Small Shrubs (1-1.5m tall)	Strapleaf Plants (0.3-1m tall)	Ground cover
<i>Eucalyptus foecunda</i> 'Fremantle Mallee'	<i>Eremophila nivea</i> 'Spring Mist'	<i>Damperia teres</i> 'Blue Damperia'	<i>Anigosanthus</i> 'Big Red'	<i>Casuarina</i> 'Cousin It'
<i>Eucalyptus forrestiana</i> 'Fushia Mallee'	<i>Chamelaucium</i> 'Lady'	<i>Eremophila microtheca</i> 'Purple Eremophila'	'Bush Ballad'	<i>Scaevola</i> 'Mauve Clusters'
<i>Melaleuca lanceolata</i> 'Rottnest Island Tea Tree'		<i>Grevillea</i> 'Gild Dragon'	'Federation Flame'	'Purple Fan Fare'
		<i>Melaleuca tetragona</i> 'Purple Melaleuca'	<i>Ptilotis</i> 'Little Joey'	'Pink Perfection'
		<i>Thryptomeme saxicola</i>		
		<i>Verticordia densiflora</i> 'Feather Flower'		

Waterwise Garden Designs



“Urban Edge”

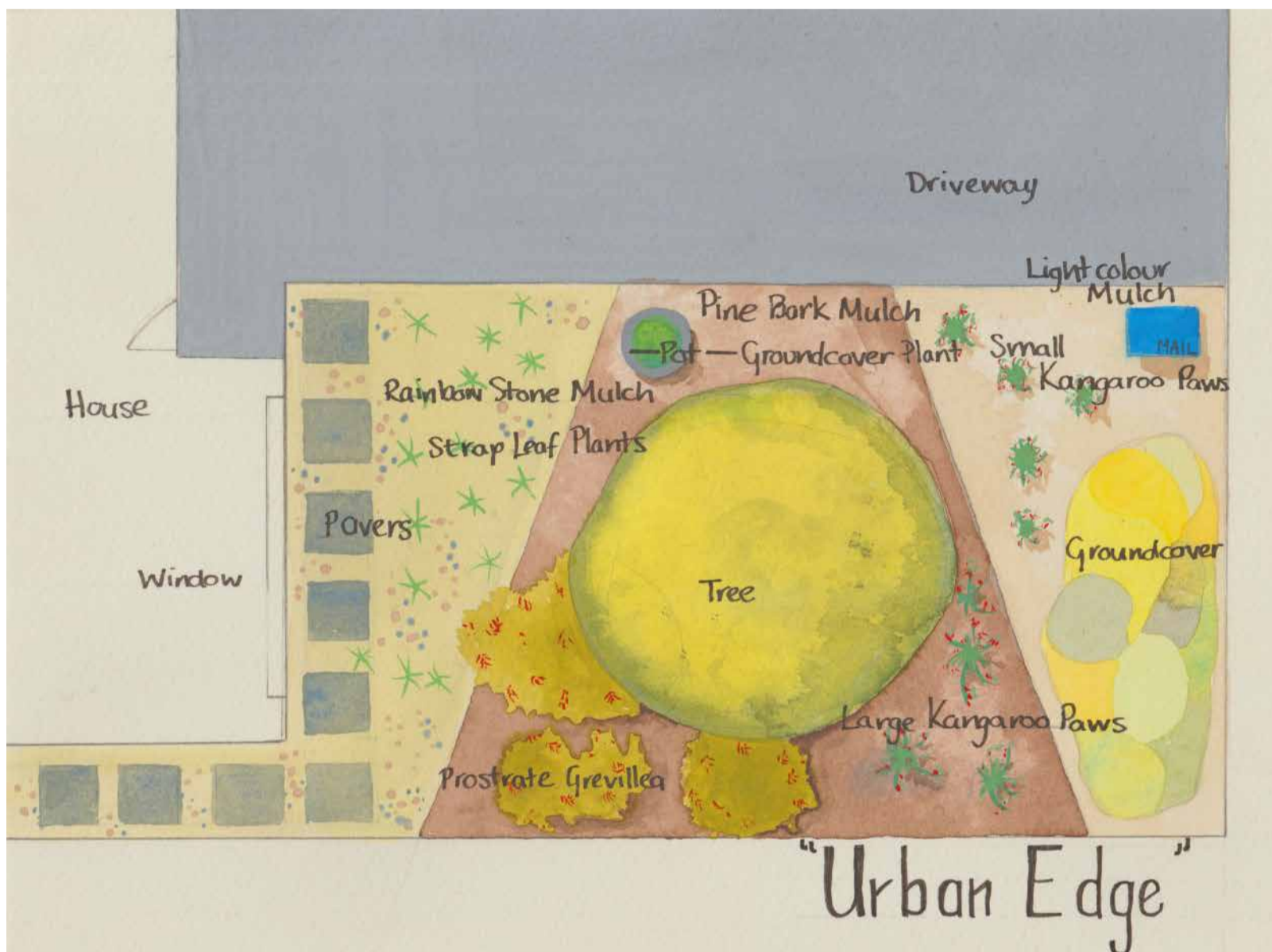

To ensure your garden thrives in our tough conditions, it will feature latest advances in sustainable landscaping. This includes;

- Special soil amendments
- Super tough waterwise plants
- Drip irrigation
- Specialist wetting agents
- Superior mulches
- Hard landscaping bonuses

Indicative Species List

Trees (small, 4-12m tall)	Colourful Cultivar Small Strapleaf Plants	Small Shrubs (1-1.5m tall)	Strapleaf Plants (0.3-1m tall)	Ground cover
<i>Olea euopaea</i> 'The Olive'	<i>Dianella</i> 'Little Jess'	<i>Grevillea</i> 'Gild Dragon'	<i>Anigosanthus</i> 'Big Red'	<i>Acacia saligna</i> 'Prostrate'
	<i>Dianella revoluta</i> 'Silver Streak'		'Bush Ballad'	<i>Casuarina</i> 'Cousin It'
	<i>Lomandra</i> 'Taneka'		'Federation Flame'	<i>Hemiandra pungens</i> 'Snake Bush'
	'Stanhope'		<i>Dianella caerulea</i> 'Weeping Dianella'	<i>Enchylaena tomentose</i> 'Creeping Berry Bush'
	<i>Poa</i> 'Eskdale'		<i>Dianella revoluta</i> 'Dianella'	